



6208-Z Deep groove ball bearings

- SKF Explorer

Deep groove ball bearings

Bearing data

[Tolerances](#),

Normal (metric), P6, P5, Normal (inch),

[Radial internal clearance](#),

Matched bearing pairs, Stainless steel
 $d < 10$ mm, Other bearings

Bearing interfaces

[Seat tolerances for standard conditions](#),

[Tolerances and resultant fits](#)

Technical specification

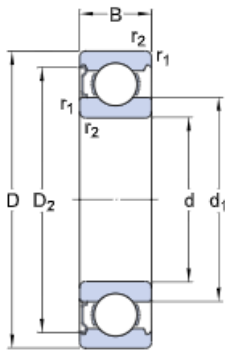

DIMENSIONS

| | | |
|-----------|-------------|-------------------|
| d | 40 mm | Bore diameter |
| D | 80 mm | Outside diameter |
| B | 18 mm | Width |
| d_1 | ≈ 52.6 mm | Shoulder diameter |
| D_2 | ≈ 69.8 mm | Recess diameter |
| $r_{1,2}$ | min. 1.1 mm | Chamfer dimension |

ABUTMENT DIMENSIONS

| | | |
|-----------------|---------|-----------------------------------|
| d_{ξ} min. | 47 mm | Diameter of shaft abutment |
| d_{ξ} max. | 52.5 mm | Diameter of shaft abutment |
| D_{η} max. | 73 mm | Diameter of housing abutment |
| r_a max. | 1 mm | Radius of shaft or housing fillet |

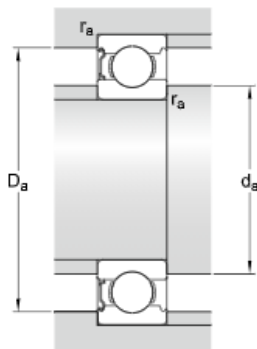

CALCULATION DATA

| | | |
|----------------|--------------|---------------------------|
| C | 32.5 kN | Basic dynamic load rating |
| C ₀ | 19 kN | Basic static load rating |
| P _u | 0.8 kN | Fatigue load limit |
| | 18 000 r/min | Reference speed |
| | 11 000 r/min | Limiting speed |
| k _r | 0.025 | Minimum load factor |
| f ₀ | 13.8 | Calculation factor |

MASS

| | | |
|--|---------|--------------|
| | 0.38 kg | Mass bearing |
|--|---------|--------------|

TOLERANCE CLASS

| | | |
|----|--|------------------------|
| P6 | | Dimensional tolerances |
| P6 | | Radial run-out |